



2020 Lakefield Skating Club Fall Session Information

September 21, 2020



2020-2021 Season Information

- ▶ Skate Canada permits the CanSkate Program for Stages 1 to 6
- ▶ **No Pre-CanSkate** Program is available at this time.
- ▶ CanSkate Program capacity is 36 skaters (Max), excluding coaches and Program Assistants (PAs).
- ▶ Registration is available only for the Fall Session at this time.
- ▶ Registration forms are available on the website www.lakefieldskatingclub.com
- ▶ Payment only to be made once registration is approved by the club
- ▶ Payments can be made by e-transfer and cheque. No cash payments accepted.
- ▶ Sessions will be 45 minutes
- ▶ Name badges will be provided on first session date and must be worn every lesson
- ▶ Attendance will be taken at start of each lesson for contact tracing purposes



2020-2021 Season Information

▶ CanSkate Stages 1, 2, 3

Mondays 6:00-7:00pm (45 min lesson) October 19 to December 21

Saturdays 9:00-10:00am (45 min lesson) October 17 to December 19

▶ Advanced CanSkate Stages 4, 5, 6

Mondays 7:00-8:00pm (50 min lesson) October 19 to December 21

▶ StarSkate

Thursdays 6:00-8:00pm October 15 to December 17



COVID-19 Protocols

- ▶ A COVID-19 Waiver must be signed and brought to arena on first session date.
- ▶ Each skater and parent/guardian **must complete a self-assessment prior to each lesson.**
- ▶ Skaters must arrive dressed to skate. Skates can be put on in arena (or if preferred skaters can come with skates on with skate guards).
- ▶ One parent/guardian per family group in the arena.
- ▶ 1st class - arrive at arena 20 minutes prior to start of session and line up outside Main Entrance to receive instructions.
- ▶ Entry will be allowed 10 minutes prior to start of session.
- ▶ Skaters/Parents will be assigned to a specific area within the arena.
- ▶ Parents must stay in assigned area of arena throughout the session.
- ▶ Social distancing rules are in place in the arena and on the ice.
- ▶ Masks/face coverings are mandatory in the arena, and optional on the ice.

Lakefield Arena COVID-19 Floor Plan

- All users and spectators must wear mask or face covering before entering. (*on-ice masks optional*)
- All users and spectators must maintain 6 feet (2 metres) physical distancing.

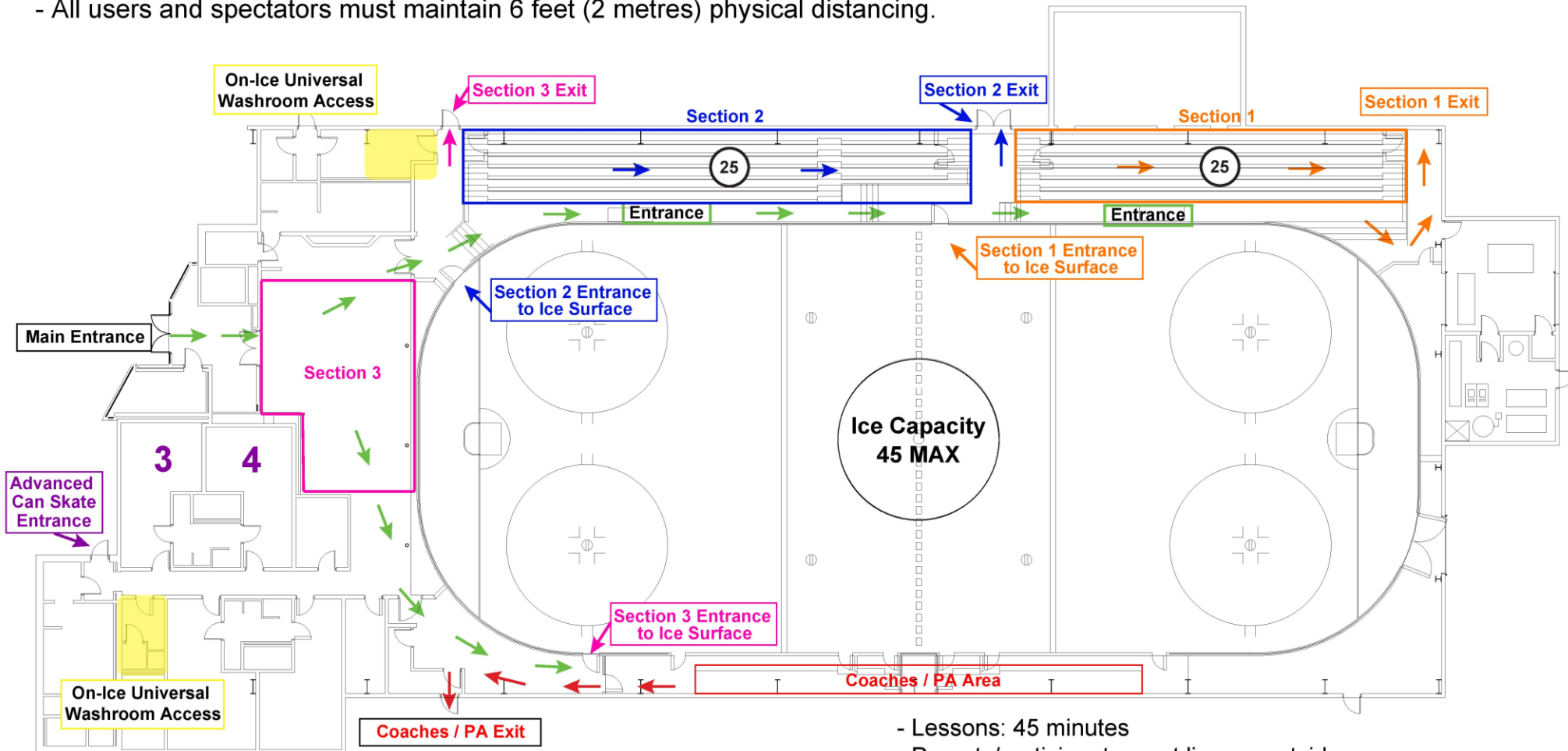

- Lessons: 45 minutes
- Parents/participants must line-up outside
- When permitted to enter, proceed directly to designated section
- Parents must stay for the **entire lesson**
- Participants can enter arena 10 minutes prior to rental
- Come dressed - skates can be put on inside arena
- One (1) Parent / Guardian / Family Member per participant